

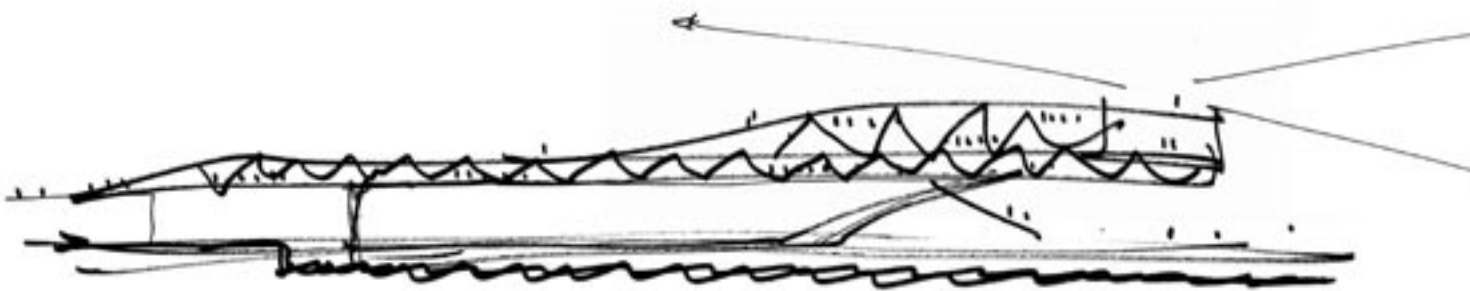

The new terminal for Stockholm will provide permanent ferry connections to Finland and the Baltics. c for the new urban development Norra Djurgårdsstaden - both architecturally and environmentally. The terminal, which will have a facade covered with expanded mesh, recalls the shape of a moving vessel and the architecture - with large cranes and warehouses - that previously characterized the ports. At the same time, the terminal has an ambitious sustainable profile, characteristic of the entire development.







© C. F. Møller Architects. All rights reserved. No part of this publication may be reproduced, stored in a retrieval system, or transmitted, in any form or by any means, electronic, mechanical, photocopying, recording, or by any information storage and retrieval system, without the prior written permission of C. F. Møller Architects.

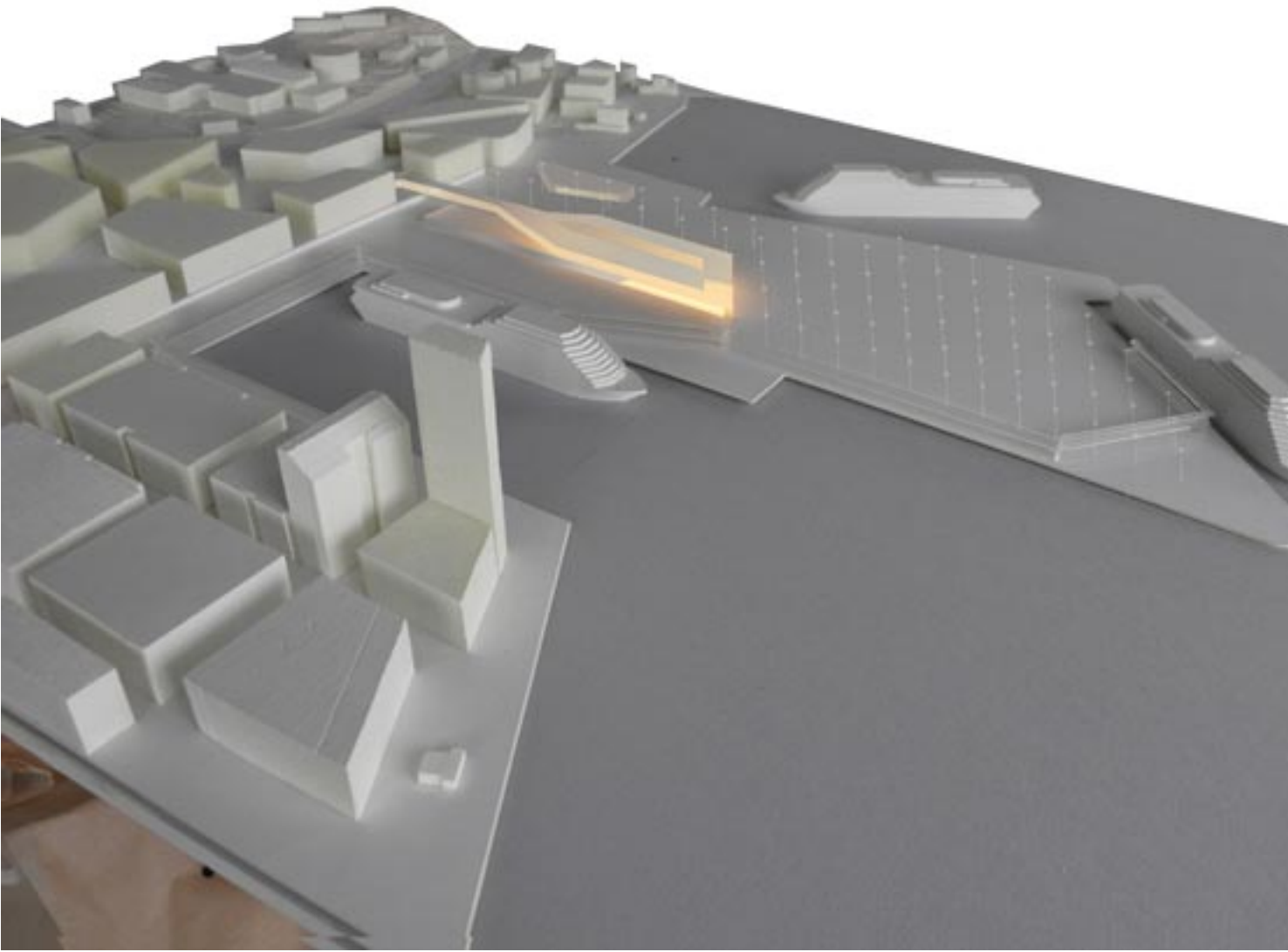



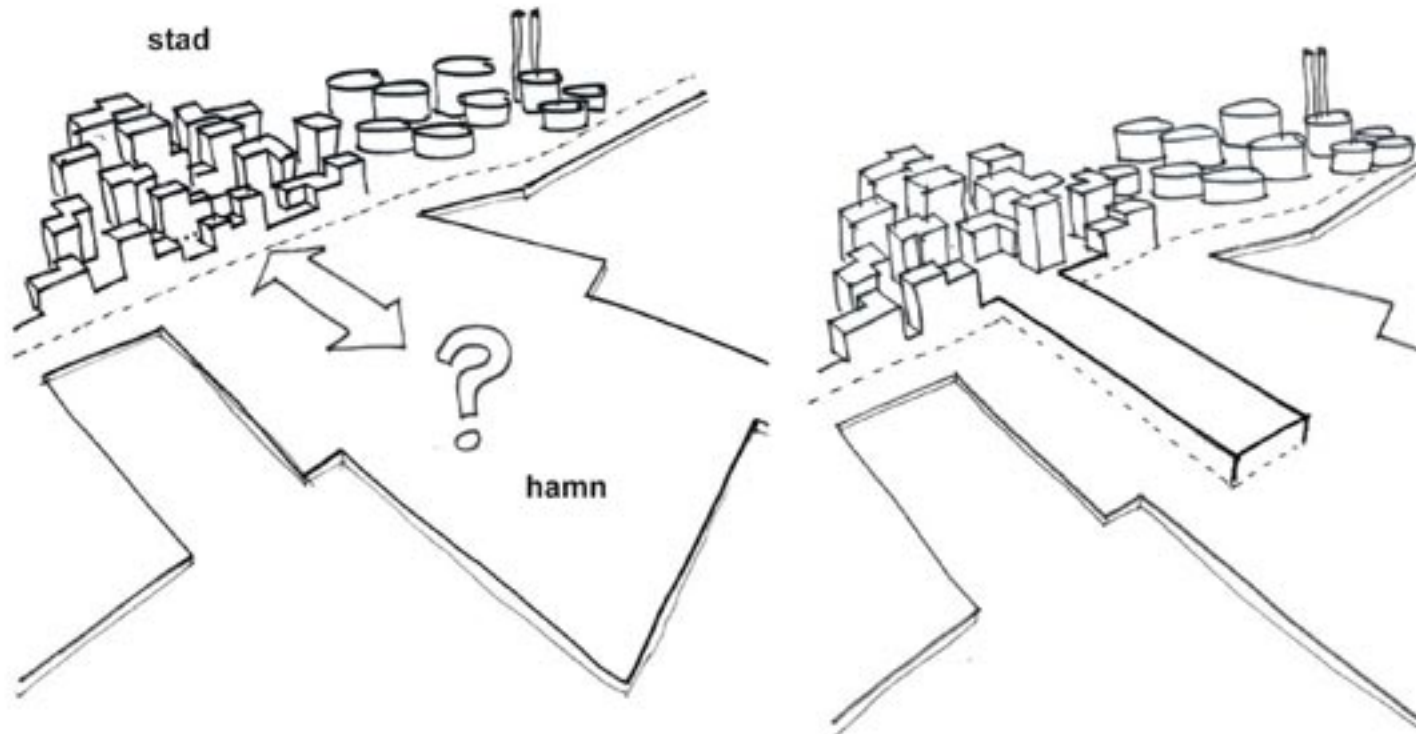



Architectural rendering of the new ferry terminal in Stockholm, Sweden, designed by C. F. Møller Architects. The building has a white, angular facade and a large glass section. The area is 100 m<sup>2</sup>.



**More...**

[{gallery}Gal/100303{/gallery}](#)