



Katsuhiro Miyamoto thrives on designing dwellings on challenging sites. As we saw in

projects previously featured on Archinnovations, the architect carefully composes his projects from the constraint imposed by the surrounding density of the urban landscapes, developing his ideas despite the awkwardness of the site's shapes and dimensions.

He proposes solutions that possess a powerful in their visual appeal while staying focused on the functional requirements of the house and the creation of user-centric living space.



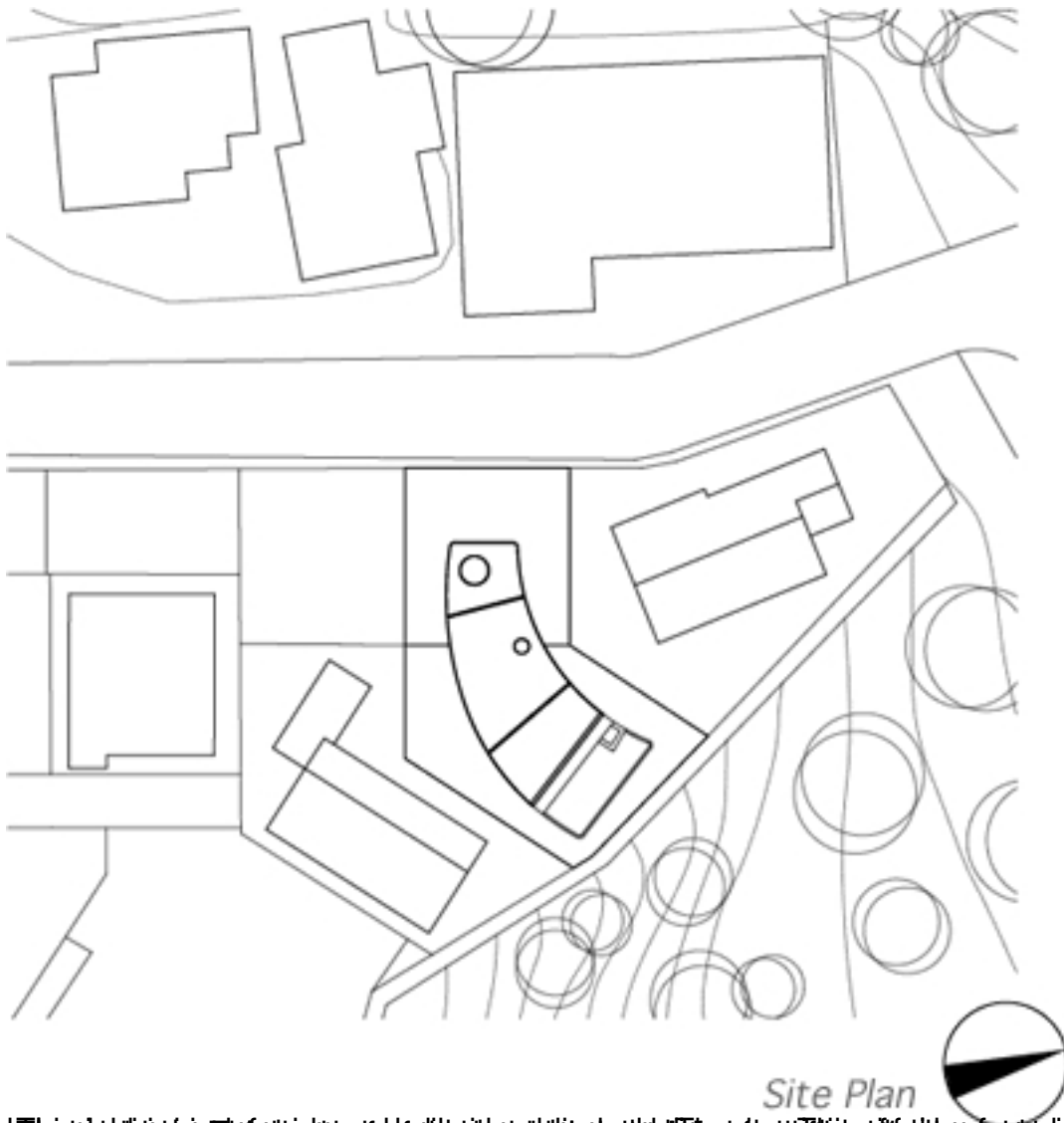

Site Plan

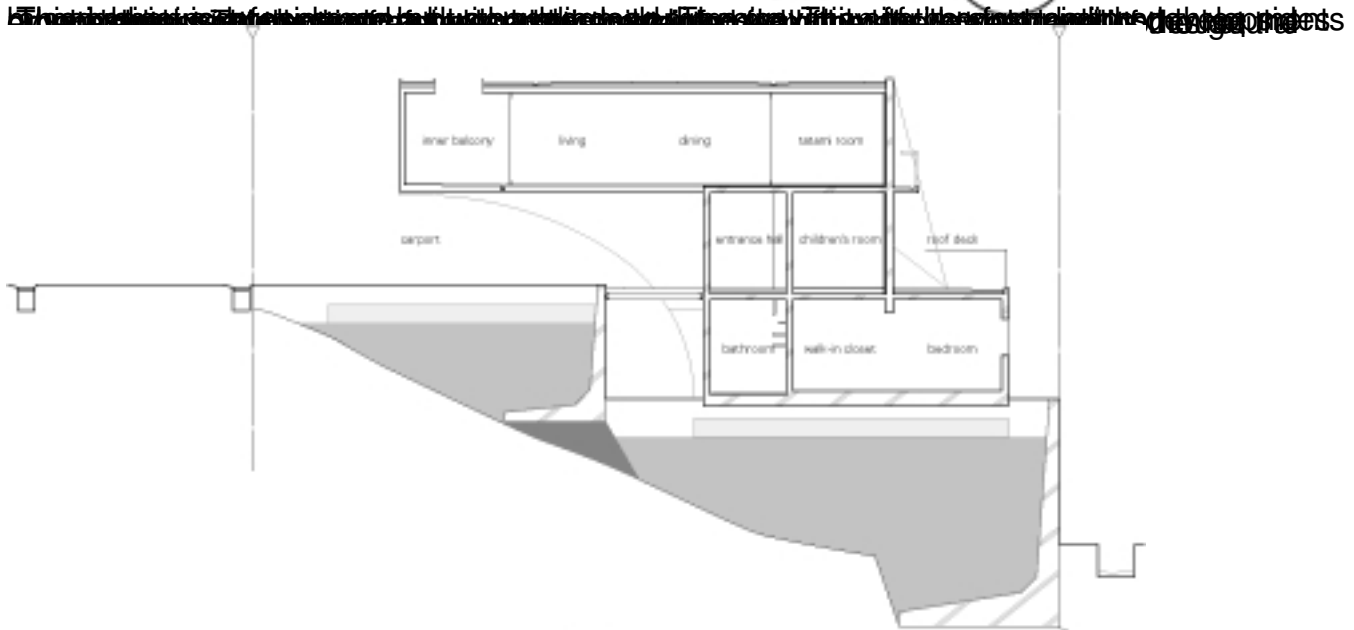

Floor Plan





6/11/2011 10:04 AM The following information is for informational purposes only and does not constitute an offer of any financial product or service. It is not intended to be used as a basis for investment decisions. Please consult your financial advisor for more information.





Project Description and Credits by Associates, Principal-in-charge, Katsuhiro Miyamoto, Tea
Swamp, 2008, 1000sqm, 2500sqm, 1000sqm, 2500sqm, 1000sqm, 2500sqm, 1000sqm, 2500sqm, 1000sqm, 2500sqm