



□

**The home gently rests on a knoll in a neighborhood located in Scottsdale, Arizona. The east and west ends are supported by steel columns, making the structure appear as if it is hovering above the desert floor.**

The entry to the home is a promenade enclosed by the walls of the 4 car garage to the north, and the walls of the residence to the south. This feature directs the home owner or visitor to the main entry door. The axis of the cantilevered overhang above the entry continues to the opposite end of the house, above the south patio and deck.

Photographs by Bill Timmerman



- LIVING / DINING 1
- KITCHEN 2
- MASTER BEDROOM 3
- MASTER BATH 4
- MASTER CLOSET 5
- GUEST B.R. / BATH 6
- HOME OFFICE 7
- POWDER ROOM 8
- LAUNDRY 9
- MECHANICAL 10
- POOL PATIO 11
- GARAGE 12

FLOOR PLAN

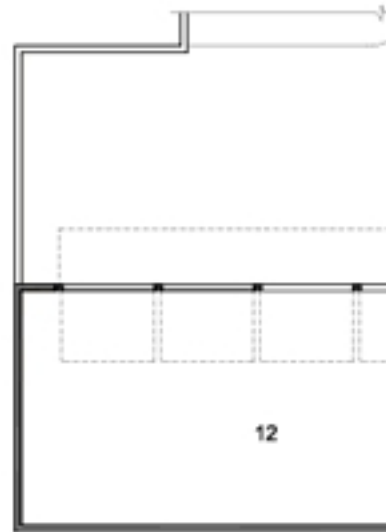





While building your business, you should also be building your brand. A strong brand identity is essential for success in a competitive market. It helps you stand out from the crowd and build a loyal customer base. Your brand should be consistent across all touchpoints, from your website to your social media to your customer service. This consistency builds trust and recognition, which are key to long-term success.



Photo credit: Michael Johnson Design Studios. The image is provided by Michael Johnson Design Studios as a courtesy.