

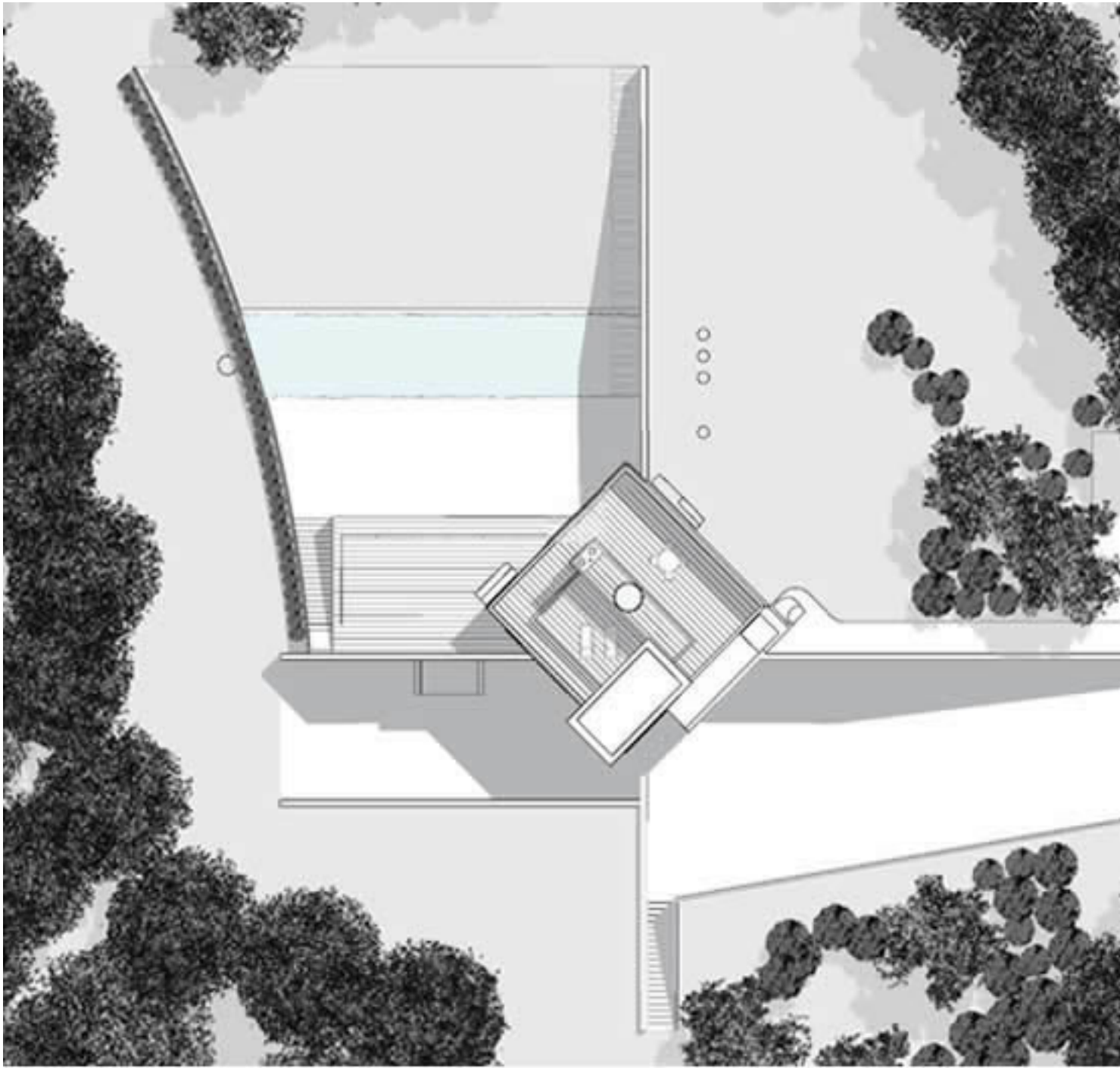

Another project within our series featuring the **recipients of the 2009 AIA Housing Award**. According to the Architects, his primary challenge was to design for the needs of a yet-to-be-determined client.

Another significant issue was how to root the house to the earth; the nearly flat site in a young growth forest offered no footing. The architects responded by reshaping the topography, establishing the first level slightly below grade and sculpting the surrounding terrain into a gentle rise.

Photographs by Michael Moran Photography, Inc.







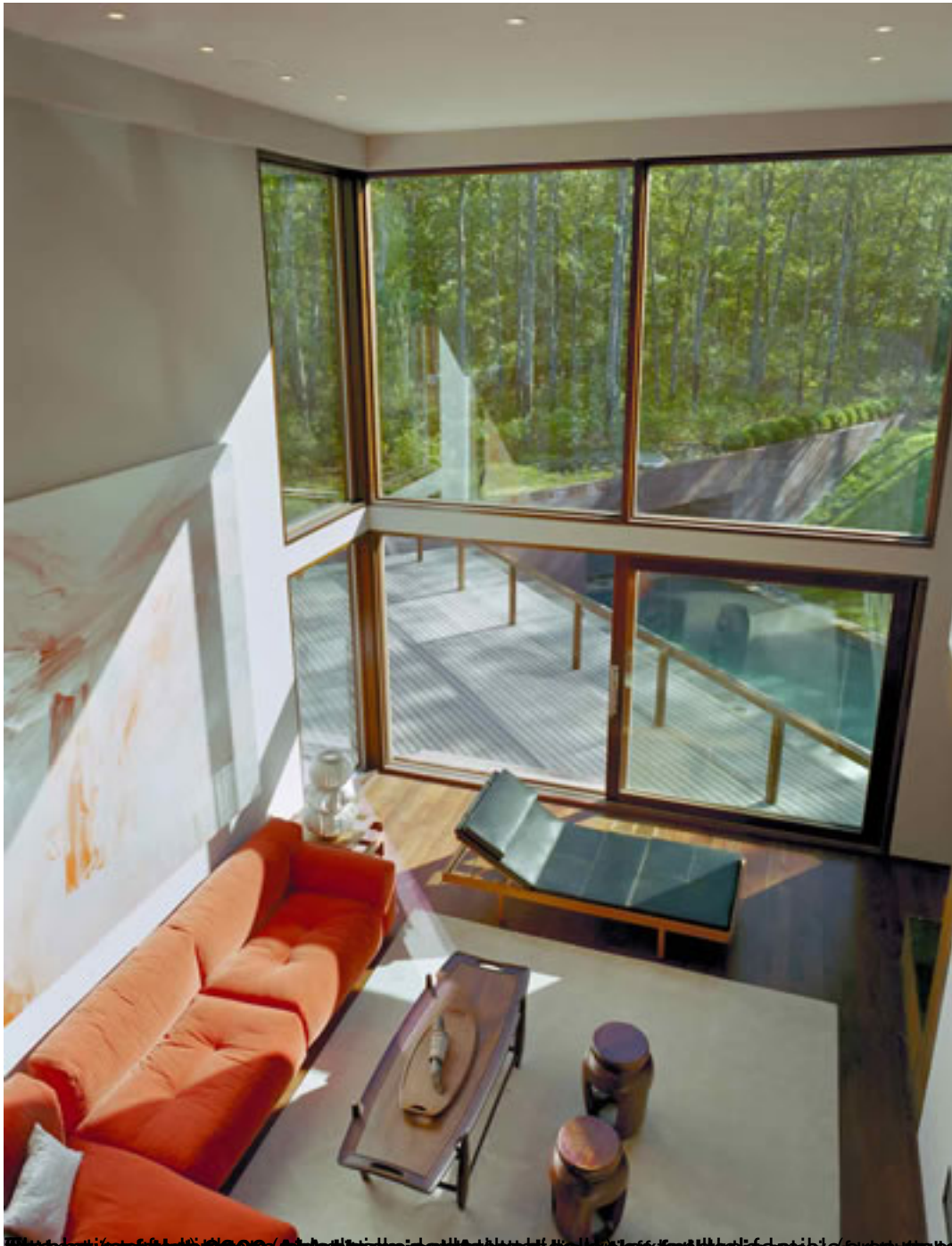

The view from the living room looking out over the pool and forest.







Project: House at Sagaponac in Wainscott, New York. Photographed by William Armstrong Design.