

**Perched atop a ridgeline in the Hollywood Hills, the presence of the Skyline Residence represents an honest approach to creating an environmentally sensitive building without sacrificing beauty nor budget.**



The pre-existing site presented a challenge in terms of constructability, the client presented the challenge of limited allowable expenses, and the architect was resilient to marginalize beauty and originality. The requirements of an architecture to satisfy each of these constraints are found in that which is constant and continuous at a given site.

Capitalizing on and working within the physical, visual, and psychological characteristics of a

given site fosters value in the relationship between building and site. Beyond incorporating various sustainable strategies out of pure concern for the environment, the budgetary limitations imposed on material choice forced the architect to implement strategies for using resources in close proximity to the site. While the building is not fused with the ground formally, it's relationship to ground, sky and the elements through a comprehensive understanding of locality is symbiotic.

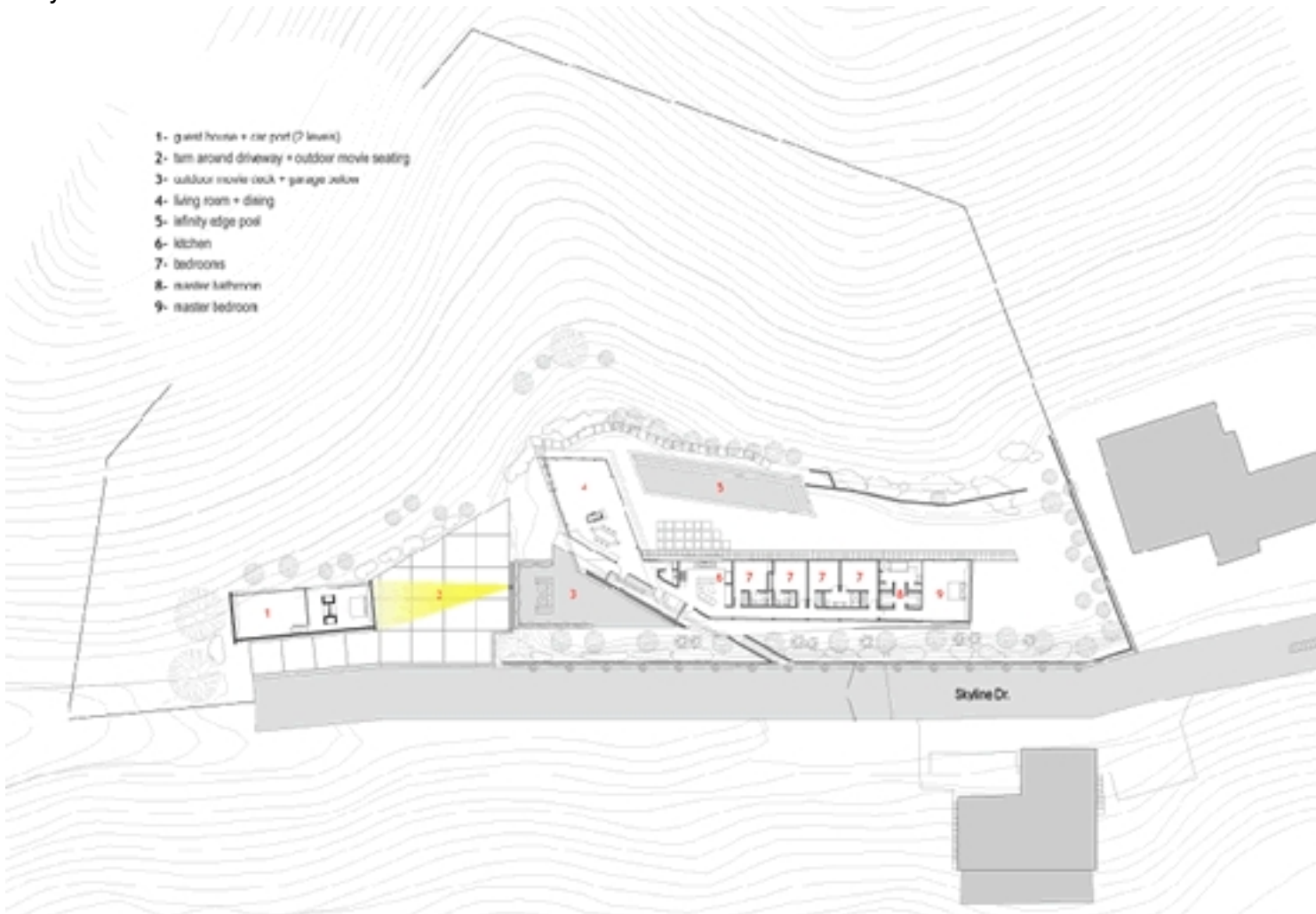

Site plan (click to enlarge)

### Site Observations

Because the site exists along a ridgeline, the shape of workable land was generally narrow and linear abutted at both sides by steep, brush-covered hillside. The workable area was also compressed by an easement flanking the Southwestern edge. The earth itself is partially composed of granite implying difficulty for excavation. Simultaneously, the root system of the

surrounding brush helps to prevent the less solid areas of earth from sliding making the occupation of the hillside a feat which would require ample resources and additional equipment.

Beyond the physical constraints, opportunity presented itself by realizing viewing angles in comparison to solar angles. Each had the capacity to compliment each other in order to maximize natural lighting and views without increasing future cooling demands.



### **Sustainable Initiatives That Are Affordable?**

From the beginning, incorporating sustainable design strategies was a guiding principle in developing the design.







Windows are only a few inches from the ground, and the building is set on a slope of about 10 feet. The building is a perfect example of modern architecture in a desert setting.





Placeholder text for the image content.





© 2009 Belzberg Architects. All rights reserved. No part of this publication may be reproduced, stored in a retrieval system, or transmitted, in any form or by any means, electronic, mechanical, photocopying, recording, or by any information storage and retrieval system, without the prior written permission of Belzberg Architects.



The following information is provided for informational purposes only and does not constitute an offer or recommendation of any financial product or service. It is not intended to be used as a basis for investment decisions. Please consult your financial advisor for more information.



PHOTOGRAPH BY BELZBERG ARCHITECTS FOR ARCHITECTURE DIGEST



Copyright © 2009 Belzberg Architects. All rights reserved. No part of this document may be reproduced without the written permission of Belzberg Architects.

