



**Ralph Ellison High School is named for the African-American writer whose novels and essays were transformative in the realms of literature, history and the African-American identity.**

Located on the South Side of Chicago, CICS Ellison wants to a difference in the lives of students in Chicago, by offering its students “a college preparatory education emphasizing rigor, relevance, and responsible leadership”.

As explained by OWP|P, the design sought to reflect Ellison’s legacy in the design. The front elevation of the addition is a glass curtain wall sandblasted with a quote from Ralph Ellison. The text is visible both from the interior library and science spaces and from the exterior to passersby and the community.



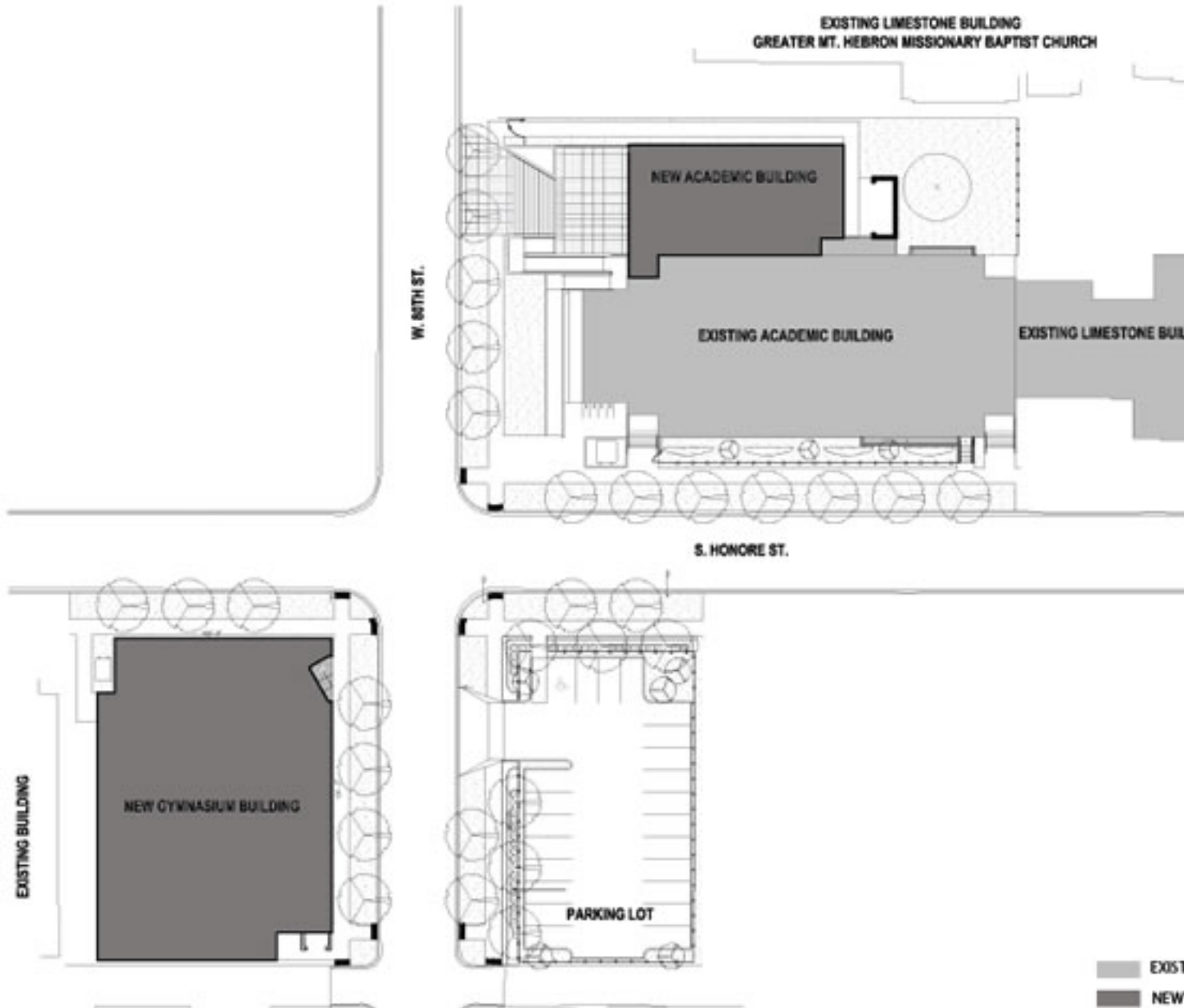

For a complete list of projects, visit the ASHES website at [www.ashes.org](http://www.ashes.org). The ASHES website is a comprehensive resource for information on the ASHES program, including a list of projects, a map of the ASHES program area, and a list of ASHES program partners.





Photograph ©



Photograph ©

60000, signifying the university's 60th anniversary, and also to honor the addition of the new building to the campus.



Photograph © [unreadable] The image is a photograph of a modern building with large glass windows and a brick base, viewed from a low angle looking up. The sky is blue with light clouds. A person is walking on a wide set of concrete stairs in the foreground. The building's facade features large glass panels with some text visible, including 'LIGHT' and 'cause i'. The word 'Photograph' is partially visible in the bottom right corner of the image.



Photograph







Photograph courtesy of Citicorp. From the 2009 CAE Educational Facility Design Awards.

Photograph